

- Notes:
- 1) Clean and degrease
  - 2) Remove all burrs
  - 3) Tolerances unless stated:  
Linear  $\pm 0.1\text{mm}$ , angular  $0.25^\circ$
  - 4) Drill and ream
  - 5) Surface texture  $\sqrt{1.6}$

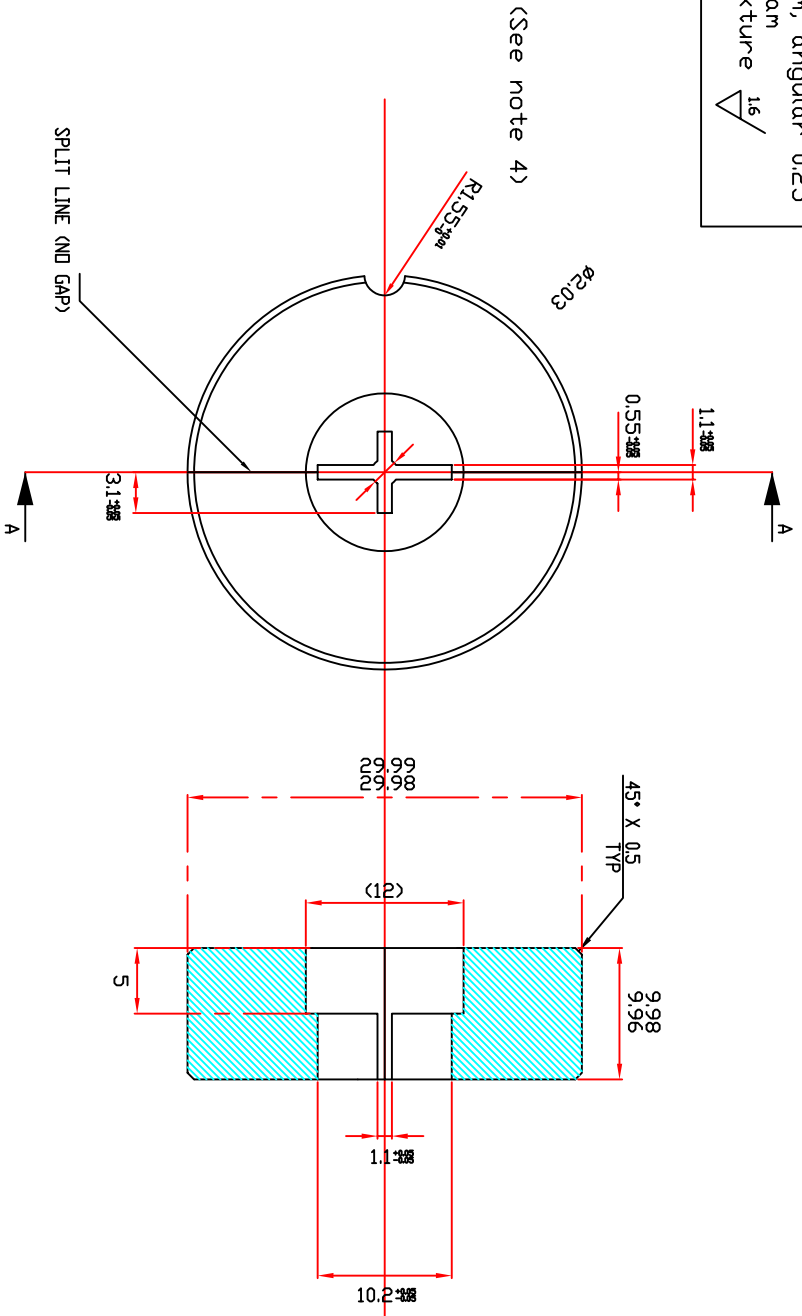

THIRD ANGLE PROJECTION DRAWING PREPARED IN ACCORDANCE TO BS308		GENERAL SURFACE FINISH: $\mu\text{m}$ CLA $R_a$ UNLESS OTHERWISE STATED MATERIAL: Free Cutting Non-Magnetic Stainless Steel - 316		HEAT & SURFACE TREATMENT DIMENSIONS: mm		TITLE SPLIT LOWER BEARING - 2 PIECES		ALL PROPRIETARY RIGHTS IN THE SUBJECT MATTER HEREOF ARE RESERVED BY SHEFFIELD UNIVERSITY AND NO PERMISSION IS GRANTED TO REPRODUCE THIS PRINT IN WHOLE OR IN PART, OR TO DISCLOSE ANY OF THE INFORMATION UNLESS IT TO OTHERS.	
SCALE: 5 : 1 DATE: 4/10/07		DRAWN: M. MOHAMMAD TD-1116-010		UNIVERSITY OF SHEFFIELD DEPARTMENT OF PHYSICS & ASTRONOMY SHEFFIELD S3 7RH Tel: 0114-2223547		PIN HOLE ADDED INITIAL ISSUE		MM RN MM RN CHK APP.	
RAL REF: TD-1116-010		DRAWING NUMBER TD-SU-01A		A4		ISSUE DATE NOTES		A 19/10/07 4/10/07	